

Bremer 18



The Bremer 18 boasts a floor plan with 3 bedrooms and 2 bathrooms, offering an intimate embrace of family living. The heart of the home unfolds in an open-plan kitchen and dining area, leading to an alfresco for seamless indoor-outdoor enjoyment. The master suite, complete with an ensuite, promises a private haven, while additional bedrooms are thoughtfully placed for tranquillity. This single-storey design efficiently uses space, ensuring every part of the home is a testament to comfortable living.

EMERGE

House Area

165.7 m²

Min Lot Size (WxL)

10m x 28m

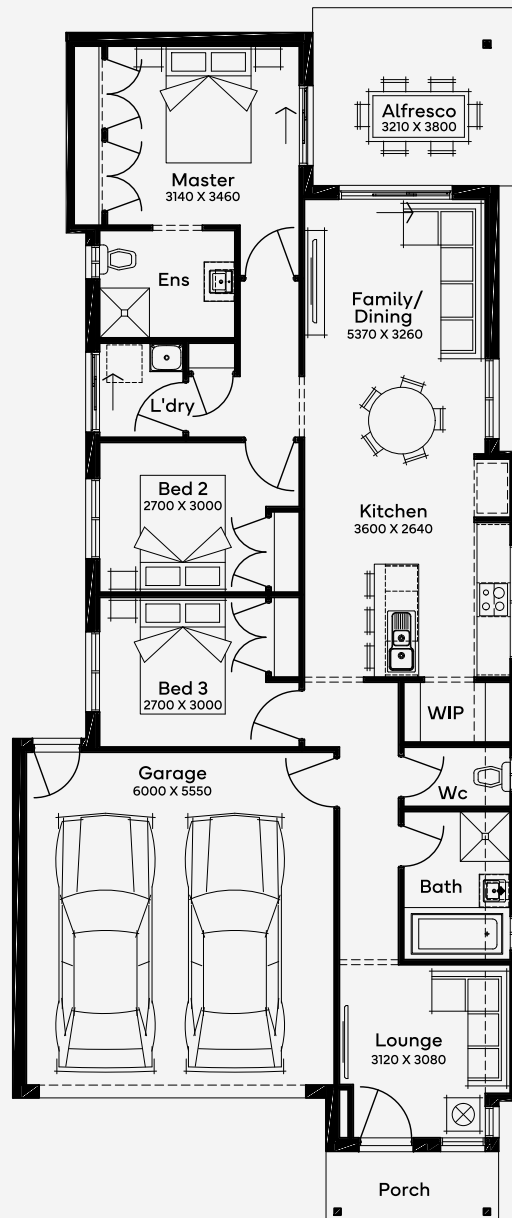

10M+ LOT WIDTH

SINGLE STOREY

Please note: Some floorplan option combinations may not be possible together. Please speak to a New Home Specialist.
Base price shown as of 07 May 2026 and is subject to change.

