

# Olivine 23

4 2 2

The Olivine 23, suitable for 12.5m+ blocks, includes 4 bedrooms, 2 bathrooms, and a 2-car garage over a single-storey. Discover what home sweet home really feels like in this exquisite floor plan, that features a large, open-plan living and dining area. The alfresco is large enough for outdoor settings, visible from the kitchen, making it an entertainer's dream. A home office and movie room provide versatility, ensuring everyone has their space while allowing for family bonding.

EMERGE

House Area

218.63 m<sup>2</sup>

Min Lot Size (WxL)

12.5m x 30m

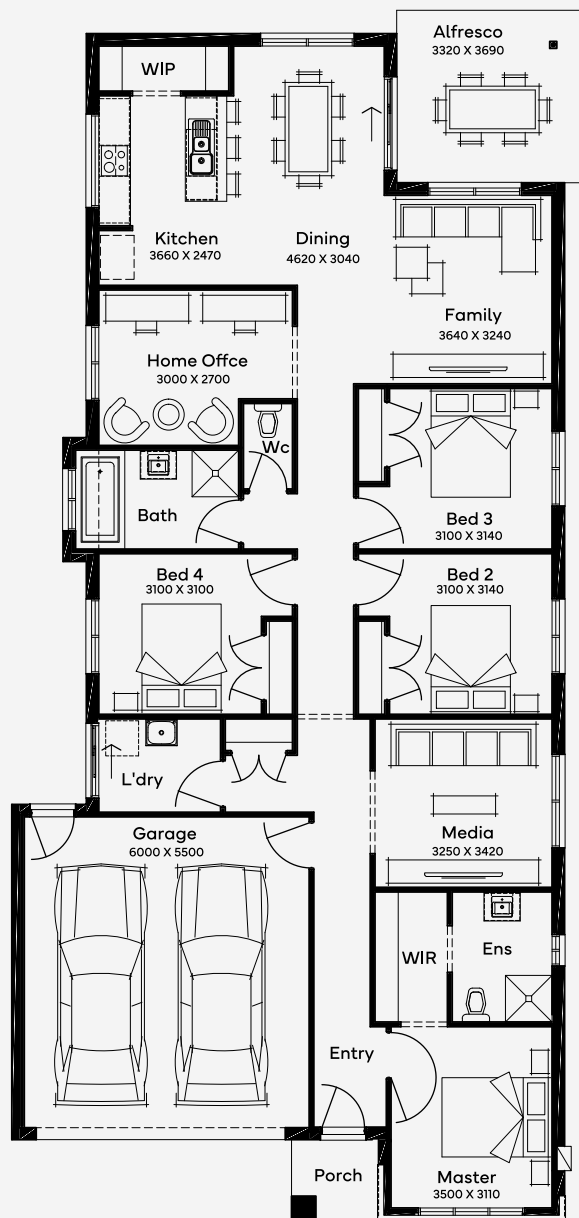

12.5M+ LOT WIDTH

SINGLE STOREY

Please note: Some floorplan option combinations may not be possible together. Please speak to a New Home Specialist.  
Base price shown as of 07 May 2026 and is subject to change.

